



Malö Yachts 39

'Shamwari'

GBP 220,000.00 UK VAT paid

The Malö 39 is a solid, fast, offshore cruising yacht with a large cockpit, generous saloon and 2 double cabins. There is extensive storage space in 2 large cockpit lockers and throughout the interior. This example has an ensuite shower room to the main cabin. Shamwari has been much loved and lightly used, up to 2019 in Dutch ownership and very lightly sailed during short seasons with winters in a heated hall. Sold to a UK owner in 2019 who was forced by Covid to change plans and sell her in 2021. The current owner spent a few months upgrading her equipment for long-term cruising and cruised as far as the Mediterranean before returning to the UK. Now unexpectedly available for sale due to a change in the owner's plans 'Shamwari' is prepared for long distance sailing and presented in superb condition. Highlights include furling staysail, new standing rigging, new saloon upholstery, solar panel charging and teak decks in excellent condition with sails that have only been used for 6 months since new. She is ready to sail away. Full details and equipment list below. We have known the boat since she came to the UK in 2019, please contact us with any questions or to arrange a viewing. Viewing is by appointment and she is ashore. Photos – November 2022 except first image below.



Built by Malö Yachts AB, Kungsviken, Sweden in 2003

Hull Length 11.99 m
Beam 3.76 m
Draught 1.83 m
Displacement 8,900 kg
Lying: Lymington, UK
Design Category A - Ocean





Hull, Deck and Cockpit

Hand laid teak on deck, coach roof and cockpit
Insulated hull with **encapsulated lead keel**
White gel coat with blue style stripe on hull and coachroof
Integral solid moulded rubbing strake
Skeg hung GRP rudder with stainless steel stock
Integrated bathing platform with teak steps and bathing ladder
Bow Thruster - Side Power
Fixed windscreen with safety glass
Stainless steel grab rails on windscreen, teak grab rails on targa arch
Targa arch with mainsheet and traveller over cockpit
Large cockpit lockers and gas locker
Extra wide opening gates in guardrail port and starboard
Jefa Rod steering and emergency tiller
Sprayhood and full height cockpit canopy (**NEW 2014**)
Folding cockpit table in teak
Cockpit lighting in targa arch
Steering pedestal with compass, bow thruster control and hand rail
Teak cupholder and winch handle holders on pedestal
Electric windlass Lofrans Kobra 1000w, wired and wireless remotes
Manson Supreme 20kg anchor (**NEW Feb 2022**)
40m chain 8mm chain
20kg Stainless steel Bruce kedge anchor and 30m chain/rope
Single bow roller
Self tailing 2 speed **Electric** Andersen Genoa sheet winches
Self tailing 2 speed manual Andersen winches 2 cockpit, 2 mast
Simpson Davits - Max SWL 150kg (pair) (**NEW March 2022**)
Custom stainless steel arch integrated into pushpit for solar panels, wind generator, aeriats/antenna (NEW March 2022)
Teak outboard motor bracket on pushpit
Fenders and various mooring warps



Electronics and Electrics

Switch panel at chart table with circuit breakers
Water and fuel gauges, Victron battery monitor and inverter control
Raymarine Radar/Plotter Axiom Pro 12" Hybrid Touch (**NEW 2019**)
Digital charts, UK and Ireland (**NEW 2019**), Mediterranean (**NEW 2022**)
Raymarine Quantum Doppler radar mast-mounted (**NEW 2019**)
Raymarine ST60 Speed, depth and multi and i60 (**NEW 2021**) wind instrument
Raymarine Autopilot with ST6001 control head on pedestal
Raymarine 240e DSC VHF, with extra cradle in cockpit and cockpit speaker
Navtex ICS Nav 6
AIS Transceiver - Raymarine 650 (**NEW 2019**)
AIS Scout antenna (**NEW 2019**)
Seataalk upgrades (**NEW 2019**)
240V shore power system including automatic battery charger with display at chart table, outlets and water heater
Domestic battery bank 500Ah (**NEW APRIL 2022**)
Engine starter battery 70Ah (**NEW OCTOBER 2022**)
Victron Inverter 375W
Solar Panels 4 x 150W and Victron regulators for charge control
Silentwind wind generator and regulator for charge control
App based monitoring for solar and wind charging
CD player/radio Pioneer, speakers in saloon and cockpit
12 volt sockets in cockpit and at chart table
USB sockets at chart table





Safety Equipment

Liferaft in canister on pushpit, 4 person Plastimo (**NEW 2019, Serviced 2022**)

Electric Bilge pump, Manual bilge pump

Fire extinguishers x 3 (**NEW 2019, Inspected Feb 2022**)

Radar reflector on mast

Jackstays (**NEW Feb 2022**) and lifeline attachment points in cockpit

Rescue Buoy

Rigging and Sails

Deck stepped Selden mast with double spreaders

Masthead rig with furling genoa and inner staysail

Stainless steel standing rigging (NEW 2022)

Running rigging including spare halyards (NEW 2022)

Mast steps to full height of mast (**NEW 2022**)

Selden rigging screw covers

Mechanical backstay adjuster

Selden In-Mast furling system

Harken Mk3 Genoa furler

Selden 200S Staysail furler

Furling Mainsail, by North Sails - used 6 months since new

Furling genoa, by North Sails - used 6 months since new

Furling staysail, by North Sails - used 6 months since new

Spinnaker halyard

Spinnaker pole (mast stowage) and control lines

Selden Rigid vang

Masthead LED Tri-colour and anchor light

LED stern, steaming and deck lights

Conventional Navigation lights on pulpit

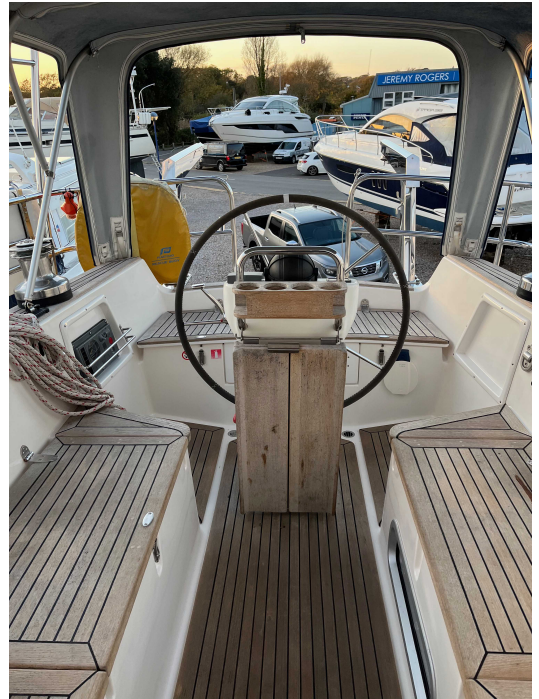

Engine and Tankage

Yanmar 57hp, 4-cylinder diesel engine - 2125 Hours

80Amp alternator charging all batteries

Fixed 3 blade propellor

Stainless steel holding tank

Stainless steel fuel tank 275 litres

Stainless steel water tanks 455 litres

Hot water tank/calorifier 40 litres

Flexible shaft coupling, Aqua Drive

Interior

Beautiful hand crafted mahogany interior in excellent condition

High quality fabric upholstery (**saloon upholstery Nov 2022**)

Pressurised hot and cold water system

Hot water calorifier with electric immersion heater

Diesel fired Eberspacher cabin heater

Heater outlets in all cabins and heads

Large chart table with seat

Easy access to engine

Wide and shallow companionway steps

Opening portlights throughout - Lewmar Atlantic

Fitted carpets throughout

Curtains to all portlights

Lighting converted to LED

Galley

Mixer tap for hot and cold water

Double stainless steel sink

Refrigerator, Isotherm SP water cooled for energy efficiency

Two burner SMEV cooker/oven with crash bar

Lid/worktop over cooker

Ample storage in cupboards, lockers and drawers

Pull out teak chopping board





Forward cabin

Large double berth with large storage below
Ventair slats below mattress
Shipshape mattress topper above **(NEW 2019)**
Numerous cupboards and 2 wardrobes
Large opening deck hatch and Opening port light

En-suite shower room

Shower with drain pump, Basin
Opening portlight

Saloon

Spacious saloon with dinette to port and sofa to starboard
Malo feature folding dining table
Malo special bulkhead lights
Sofas have lee cloth for use as sea berths
Large opening deck hatch
Opening portlights
Clock and barometer
Numerous storage cupboards and lockers

Head

Raritan sea toilet with holding tank
GRP worktop with built in sink
Mixer tap with shower head
Shower drain pump
Ample storage in lockers
Opening portlight

Aft Cabin

Large double berth,
Access to engine room and engine start battery
Good storage in numerous lockers and wardrobe
Opening portlights to cockpit and to deck
Emergency escape hatch to cockpit









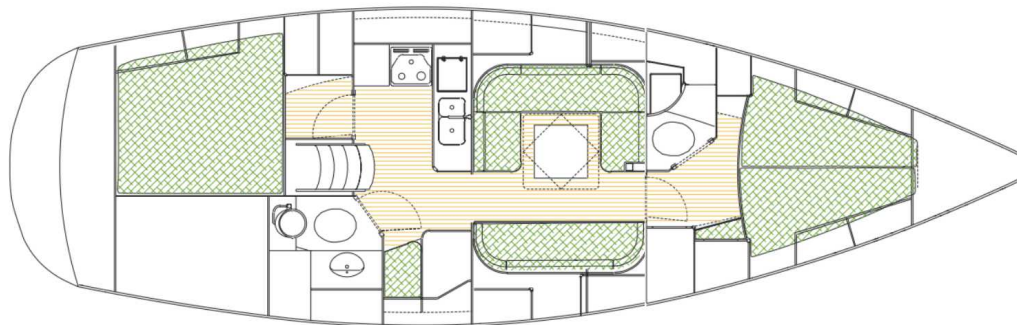

In this transaction we are acting as Brokers only. We are informed that this sale is not related to the Owner's business, trade or profession Whilst every care has been taken in their preparation, the correctness of these particulars is not guaranteed. The particulars are intended only as a guide and they do not constitute a term of any contract. A prospective buyer is strongly advised to check the particulars and where appropriate to have the vessel fully surveyed and inspected, sea trialled and opened up.