



## Malö Yachts 45



**“Altair af Skaftö”**

**EUR 315,000 EU VAT paid**

Built by Malö Yachts AB, Kungsviken, Sweden in 1998

*Malö Yachts flagship is arguably the ultimate offshore cruising yacht. Fast, powerful and superbly capable with ample storage space for cruising essentials. This hull is so good it went on to become the Malö 46 and then 47. Altair has two aft cabins and a large cabin forward, spacious saloon and generous galley. She is incredibly well equipped for long distance cruising and has been very well cared for since. Presented in lovely condition by careful and experienced owners, she is ready for new adventures.*

**Malö Yachts**

## Malö Yachts 45

**“Altair af Skaftö**

**EUR 315,000 EU VAT paid**

Built by Malö Yachts AB, Kungsviken, Sweden in 1998



*Malö Yachts flagship is arguably the ultimate offshore cruising yacht. Fast, powerful and superbly capable with ample storage space for cruising essentials. This hull is so good it went on to become the Malö 46 and then 47. Altair has two aft cabins and a large cabin forward, spacious saloon and generous galley. She is incredibly well equipped for long distance cruising and has been very well cared for since. Presented in lovely condition by careful and experienced owners, she is ready for new adventures.*

LOA	13.95 m
Beam	4.12 m
Draught	2.10 m
Displacement	14,500 kg
Mainsail	51.5 sq m
Genoa	150%
Cutter Jib	30 sq m
Engine	Yanmar 4JH2-UTE 100hp

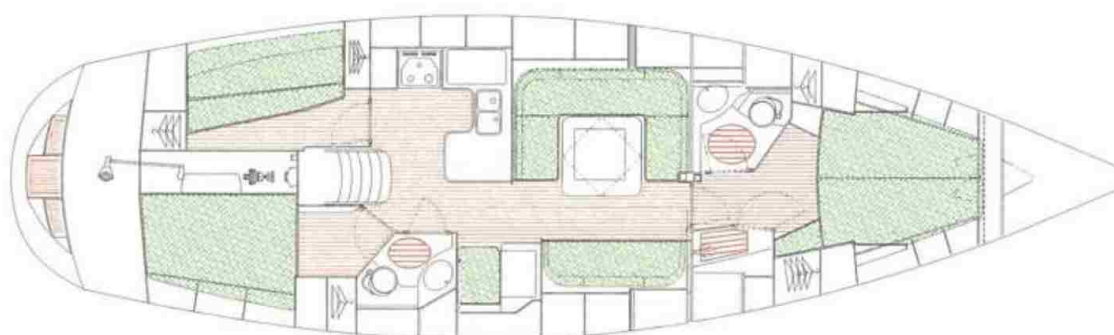

**Malö Yachts**



## Hull, Deck and Cockpit

Hand laid 12 mm teak on deck, coach roof and cockpit  
Built in transom steps in teak with swimming ladder  
Insulated hull, hand-laminated, lead keel  
Coppercoat (2014)  
Integral solid moulded rubbing strake with aluminium protection  
Teak toe rail with aluminium protection  
Bow thruster, twin prop 10hp  
Large cockpit locker under helm seat  
Separate and vented gas and outboard fuel storage lockers port and starboard  
Teal seat extensions (folding)  
Fixed stainless steel windscreen with safety glass and stainless steel handrails **(2015)**  
Spacious and deep cockpit with safety line attachment points  
Targa arch with mainsheet system over cockpit  
Cockpit lighting in targa arch  
Wheel steering with emergency tiller  
Steering pedestal with compass and stainless steel grab bar  
Electric anchor winch Lofrans 24volt **(2016)** and 30kg Stainless steel anchor, 80m stainless steel chain 10mm  
Stainless steel bow platform  
Washdown pump for anchor **(2005)**  
Stern anchor 15kg Bruce with launching bracket and Ankarolina webbing 50m  
Sprayhood and full cockpit canopy **(2015)**  
Cockpit table in teak  
Hot and cold cockpit shower  
Pushpit and pulpit in 30mm stainless steel with opening guard rails port and starboard  
Teak outboard bracket  
Flagstaff for ensign

## Rigging and Sails

Deck stepped Seldén mast with 2 sets of aft-swept spreaders  
Spinnaker pole  
Andersen electric genoa winches in cockpit  
Dyneema halyards  
Genoa cars adjustable from cockpit  
Harken genoa furling gear  
Harken staysail stay furling gear  
Fully battened mainsail **(Lundh Vectran 2015)** 3 reefs, 2 with single line system  
Furling genoa 150% **(Lundh Vectran 2015)**  
Staysail 30m<sup>2</sup> **(Lundh Vectran 2014)**  
Cruising chute 140 m<sup>2</sup> with snuffer **(2004)**  
Stackpack sail cover with integrated lazyjacks by Lundh Sails  
Main halyard, 2 reeflines outhaul and vang control led to cockpit  
Selden Rodkick **(2017)**  
**New forestay 2021**

**Malö Yachts**



## Electronics / Electrics

Raymarine ST60 speed, wind, depth instruments over companion way (2007)  
Raymarine ST60 Graphic at chart table (2007)  
Radar/plotter Raymarine E80 in cockpit (2007)  
Raymarine 2kw radar on dedicated pole on aft deck (2007)  
AIS Transceiver (2009)  
Raymarine autopilot ST6002  
DSC VHF Raymarine Ray55E with full function Raymic in cockpit (2009)  
Furuno NX300 Navtex Receiver (2004)  
Raymarine autopilot Smart Pilot 2 with Gyro (2007)  
Wireless autopilot control Raymarine S100 (2009)  
24 volt and 12 volt systems  
Engine start battery Varta 100Ah lead acid (2019)  
Domestic 12v bank – Varta 140Ah lead acid (2019)  
Domestic 24v bank – Varta 140Ah x 4 lead acid (2020)  
Switch panel at chart table with circuit breakers, fuel, water gauges  
Battmeter battery monitor  
Gobius tank gauges for holding tanks (2010)  
Shore power system with battery chargers, outlets and water heater  
Mastervolt 12 volt battery charger (2015)  
Mastervolt 24 volt battery charger (2021)  
Mastervolt Inverter 500W (2012)  
Batteries (new 2018): 420Ah Domestic, 75Ah Starting with emergency link  
AC 220V Sockets through boat  
CD/Radio Kenwood with saloon and cockpit speakers  
TV at chart table (2014)  
Combi Aerial RR Panama VHF/TV/FM radio

## Engine and Tankage

Yanmar 4JH2-UTE 100hp diesel engine  
Folding propellor 3 blade Flex-o-Fold (new hub 2006)  
Aquadrive flexible shaft coupling  
Racor water separating primary fuel filter  
24 Volt Balmar high output alternator with regulator (new 2017)  
12 Volt alternator plus spare Balmar high output alternator  
Exhaust elbow replaced 2020  
Stainless steel water tanks 600 litres  
Stainless steel fuel tank, 495 litres  
Extra fuel tank 100 Litres with transfer pump  
Stainless steel holding tanks with deck / through hull discharge



## Safety Equipment

Manual and 2 electric bilge pumps  
Radar reflector Echomax  
Webbing jackstays  
Emergency Tiller  
Tri colour mast head lantern with anchor light LED (2008)  
Navigation lights, side, stern, steaming LED (2017)  
Fire extinguishers

**Malö Yachts**



## Interior

Beautiful hand built mahogany interior in outstanding condition

Two cabins aft, with large main cabin forward

Large galley and saloon

Leather upholstery in excellent condition (NEW 2014)

Most lighting converted to LED

Pressurised hot and cold water system

Eberspacher D4 diesel cabin heater, saloon and forecabin (2010)

Eberspacher D1 diesel cabin heater, aft cabins (2010)

Fitted carpets throughout

### **Galley**

Double stainless steel sink

Cooker with oven and grill – Force 10

Microwave 230v

Isotherm SP Refrigerator 75 litre

Isotherm SP Refrigerator 75 litre

Ample storage space

### **Saloon**

Forward facing chart table with seat

Dinette with large, extending dining table to port

Sliding sofa to starboard with removable arm rests

Bookshelf to main bulkhead

Ample lockers and book shelving

Clock and Barometer

### **Forward owners cabin**

Large double bed with new mattress (2015) and drawers under

Lockers and shelves port and starboard

Mattress topper (2015)

Storage in cupboards and wardrobes, large mirror

Large opening hatch with blind

Opening port lights

### **En suite heads compartment**

Basin with single lever faucet, lockers and mirror

Jabsco electric sea toilet with holding tank

### **Separate Shower room to starboard**

Thermostatic shower mixer

Electric shower drain pump

Teak grating floor

Lockers and hanging rail

### **Starboard aft cabin**

Double berth with topper

Cupboards and wardrobe

Escape hatch above berth

Opening port lights

### **Port aft cabin**

Single berth with second single berth above

Top berth folds up when not in use

Lee cloths to both berths

Wardrobe

Escape hatch to cockpit

Opening port lights

### **Aft heads compartment**

Basin with storage cupboard under

Pull out shower head

Electric shower drain pump

Jabsco electric sea toilet

Further storage cupboards



**Malö Yachts**



**Malö Yachts**

Malö Yachts UK – Lymington Yacht Haven – Kings Saltern Road – Lymington – Hampshire SO41 3QD – +44 (0)1590 676782  
sales@maloyachts.co.uk - www.maloyachts.co.uk  
Malö Yachts UK is a trading name of DFD Marine LTD Registered Company No. 7412841

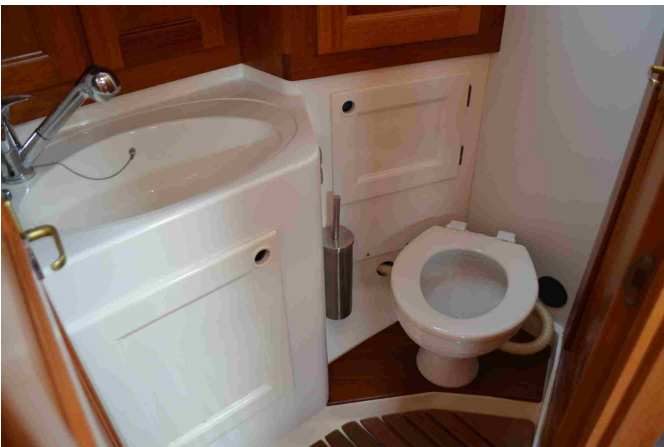
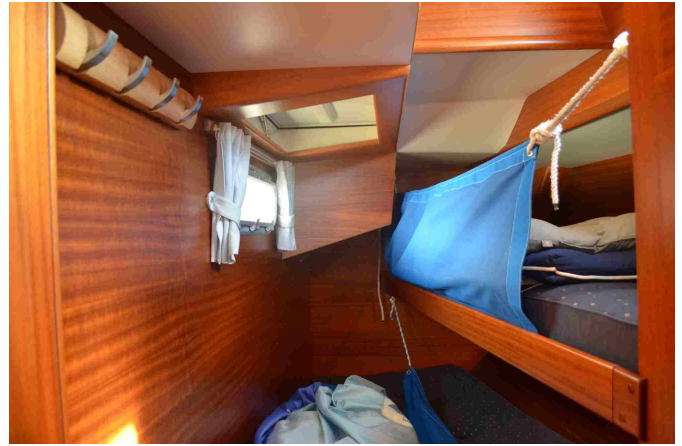
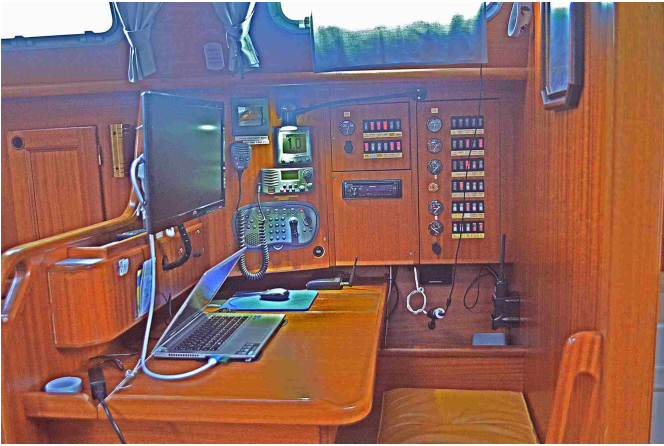

**Malö Yachts**

Malö Yachts UK – Lymington Yacht Haven – Kings Saltern Road – Lymington – Hampshire SO41 3QD – +44 (0)1590 676782  
sales@maloyachts.co.uk - www.maloyachts.co.uk  
Malö Yachts UK is a trading name of DFD Marine LTD Registered Company No. 7412841

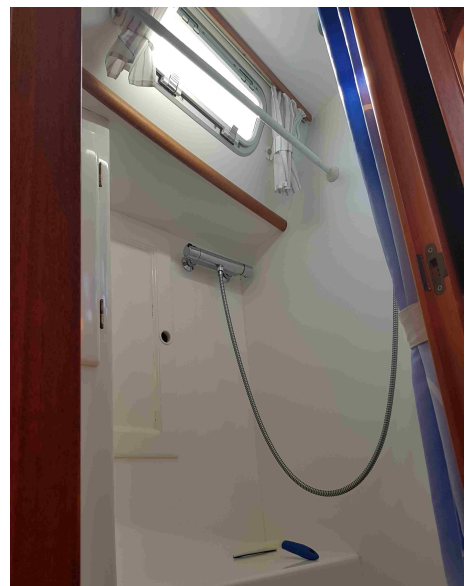

**Malö Yachts**

Malö Yachts UK – Lymington Yacht Haven – Kings Saltern Road – Lymington – Hampshire SO41 3QD – +44 (0)1590 676782  
sales@maloyachts.co.uk - www.maloyachts.co.uk  
Malö Yachts UK is a trading name of DFD Marine LTD Registered Company No. 7412841



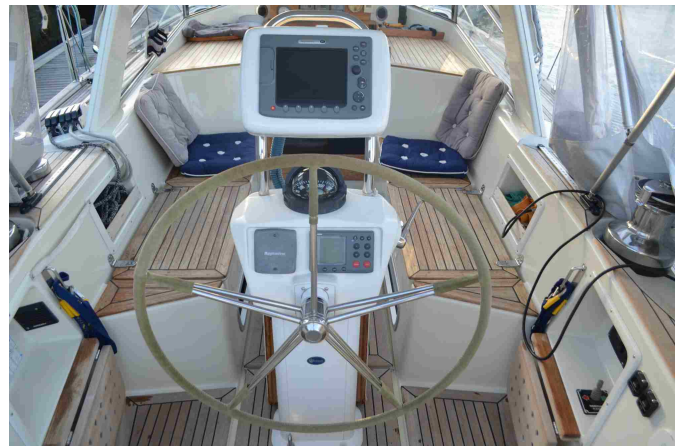

**Malö Yachts**

Malö Yachts UK – Lymington Yacht Haven – Kings Saltern Road – Lymington – Hampshire SO41 3QD – +44 (0)1590 676782  
sales@maloyachts.co.uk - www.maloyachts.co.uk  
Malö Yachts UK is a trading name of DFD Marine LTD Registered Company No. 7412841

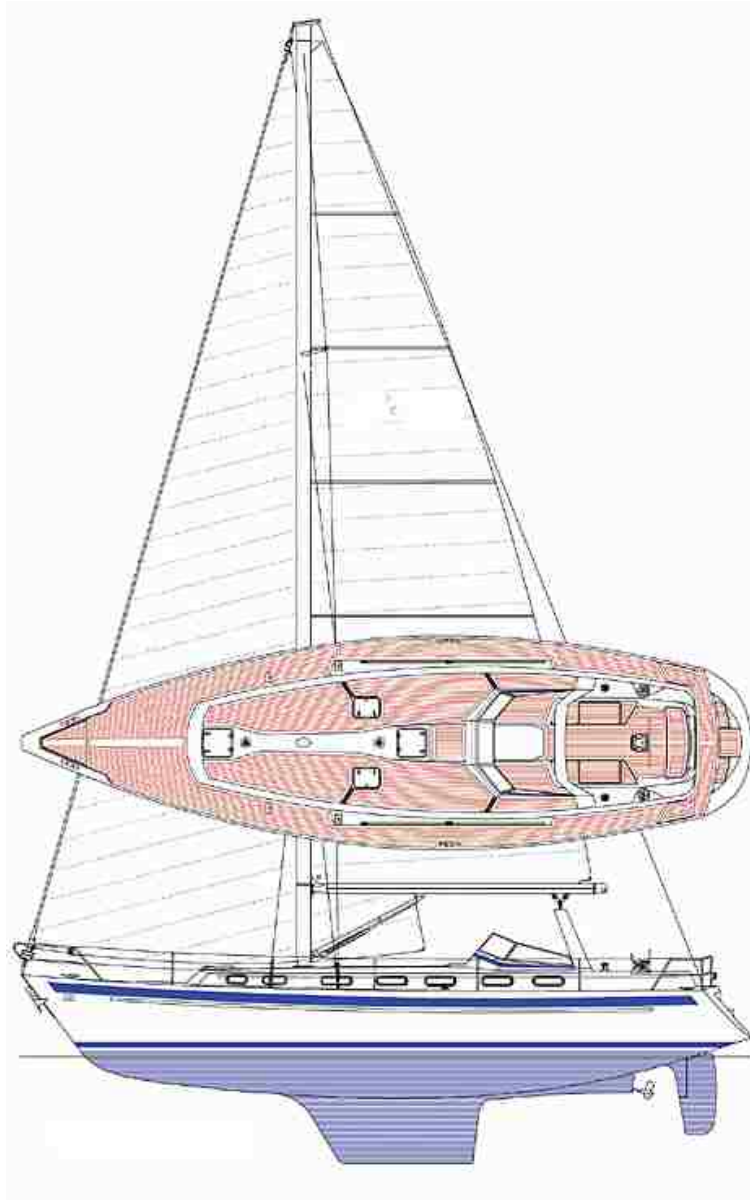

*In this transaction we are acting as Brokers only. We are informed that this sale is not related to the Owner's business, trade or profession. Whilst every care has been taken in their preparation, the correctness of these particulars is not guaranteed. The particulars are intended only as a guide and do not constitute a term of any contract. A prospective buyer is strongly advised to check the particulars and where appropriate to have the vessel fully surveyed and inspected, sea trialled and opened up.*

**Malö Yachts**

Malö Yachts UK – Lymington Yacht Haven – Kings Saltern Road – Lymington – Hampshire SO41 3QD – +44 (0)1590 676782  
sales@maloyachts.co.uk - www.maloyachts.co.uk  
Malö Yachts UK is a trading name of DFD Marine LTD Registered Company No. 7412841