



Malö Yachts 40 Number 139

“SOZO”



(photographs from launch pending new photography)

Built by Malö Yachts AB, Kungsviken, Sweden, Launched in 2010

Lightly used sailing UK and N France only.

Recent additions include removal of all antifoul and application of Coppercoat in 2017, new main and genoa and cockpit canvas 2016.

The engine has been regularly serviced and the rig was removed and inspected in 2017.



Malö Yachts



Malö 40 Standard Boat as per specification of 2009/10, plus the following items of additional equipment:

Furling mast Seldén, cockpit control, mainsail, vertical battens.
Autopilot: Raymarine Smartpilot ST 6002 (S2G) with gyro and display/control on pedestal
Raymarine Quantum radar **NEW 2017**
AIS 650 Transceiver **NEW 2015**
Raymarine Plotter **NEW 2017**
Kenwood stereo **NEW 2015**, 1 set of speakers in the saloon, 1 set in cockpit
Radar reflector, Echomax EM 230, mounted on mast.
Grab rail, stainless steel, mounted on the windscreen, port and starboard
Opening gates in lifelines amidships, port and starboard
Genoa cars adjustable, cockpit control
Navigation light tri-colour and anchor mast top light
Electric windlass in bow: 1000W 12V, mounted below deck, hand control, 40 m, 8mm chain
Shorepower: earth breakers, 3 outlets, 25 m cable, charger 12V/50A, control panel and battery monitor
Domestic Batteries, 3 x 140Ah Lead Acid, **NEW 2015**
Engine Battery, 1 x 75Ah Lead Acid
EFOY 210 Fuel cell providing 12 volt re-charging of batteries **NEW 2015**
Flexible Solar Panel 80W with Victron charge controller **NEW 2015**
Yacht Router Micro Wifi/4G router/booster with mast mounted antenna **NEW 2015**
Additional hull anode
Upgraded portlights
Bow thruster Sidepower, thrust 95 kg
Toilet- and shower module in the forward cabin, separate stainless steel holding tank
Integrated boarding platform, c/w teak on steps
Two armchairs, table with recessed bar, SB side of saloon
Folding propeller, 3-bladed Flex-o-Fold, Rope cutter Spurs on the propeller shaft
Wooden leg to saloon table
Lee cloth to port saloon berth
Detachable cutter stay complete with tensioner, halyard and sheet
Hank-on staysail
Cables in the boat for 2nd plotter at chart table
Corian Surface to galley worktop
Spare MASTHEAD halyard
Carpets throughout, replaced **2015**
Three additional 240V sockets
TV Antenna at masthead with aerial cable to saloon
Mastervolt 'AC MASTER 500W' inverter
McMurdo Nav 6 Navtex receiver, software updated 2015
Upgrade to Ray55E VHF
Extension cable to pedestal for Raymic
Spinnaker pole track on mast and Spinnaker pole control lines on mast
'Purytec' units to both heads
Stainless steel toe rail protection midships for 6 metres port and sb
Lights in Targa arch
Hot and cold shower in cockpit
Cockpit cover and sprayhood in beige
Hatch from aft heads to cockpit locker
Hanging rail in cockpit locker (removable)
Electric Genoa Winches 52STE 2 off
Viking Rescu 4 person Liferaft in cradle on pusphit
Sanders Cruising Chute **NEW 2015**
Custom bow roller **NEW 2015**
Removable bow sprit for cruising chute **NEW 2015**
Outboard motor bracket in cockpit locker
Glass bowl fuel filter and Fuel Guard filter fitted **2015**
Heater outlet added to cockpit in **2015**
Electric Toilet fitted in aft heads **2018**
Additional Solar panel fitted **2018**

Malö Yachts

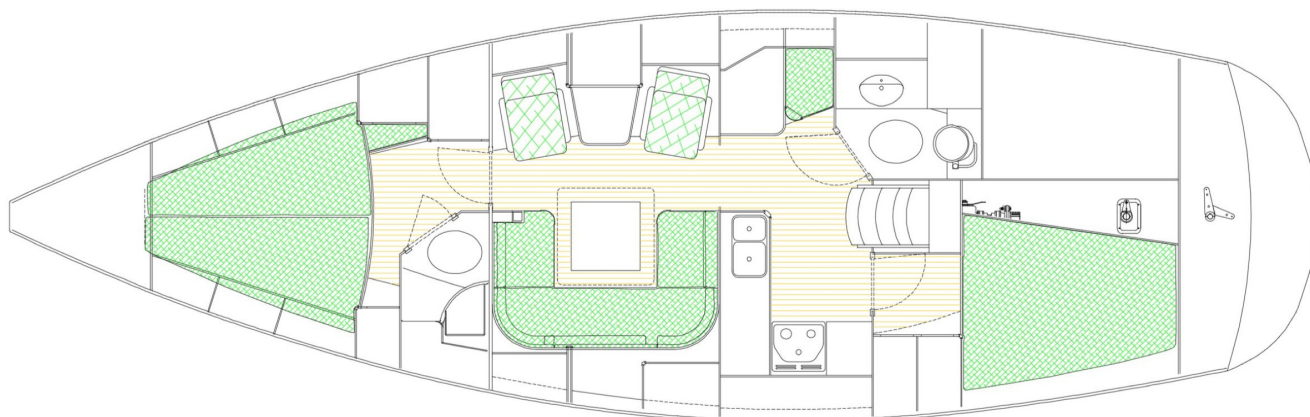

Malö Yachts

Malö Yachts UK – Lymington Yacht Haven – Kings Saltern Road – Lymington – Hampshire SO41 3QD – +44 (0)1590 676782
sales@maloyachts.co.uk - www.maloyachts.co.uk
Malö Yachts UK is a trading name of DFD Marine LTD Registered Company No. 7412841